

# Smart IT Services

[www.smart-mail.net](http://www.smart-mail.net)

Support@smart-mail.net

## Set Up IMAP - Android

To set up an older Android for IMAP, do the following:

1. From the Home screen, tap the Application button.
2. Tap the **Email** icon.
3. If this is your first email account, you will be presented with an email setup screen. Tap the **Next** button. Otherwise, press the **Menu** button, tap **Accounts**, press the **Menu** button, and tap **Add account**.
4. In the **Type your account email address** box, enter your entire email address (e.g., myname@mydomain.com).
5. In the second box, enter the password associated with your email account.
6. Tap the **Manual setup** button.

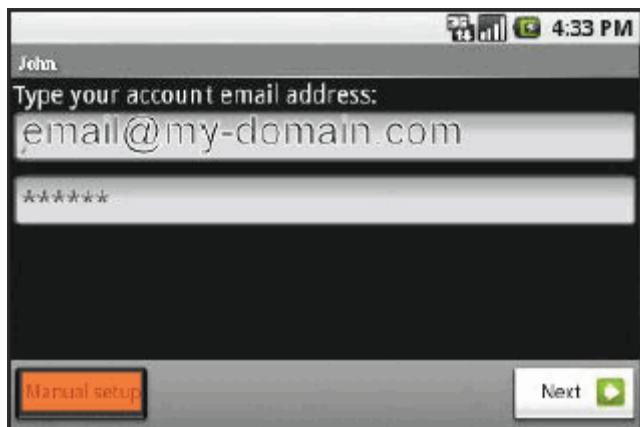

7. Tap the **IMAP account** button.
8. Enter the following information in the fields provided:
  - o Username-Enter your entire email address (e.g., myname@mydomain.com).

- Password-Enter the password associated with your email account.
- IMAP server-Enter the server name:  
**Example: mail.mydomain.com**
- Port-Enter the port number: 143
- Security type-Select **None**

**Note:** Be sure the **Port** number is still 143.

9. Tap the **Next** button. The device will connect to the internet and check your incoming settings.
10. On the **Outgoing server settings** screen, enter the following information in the fields provided:

- SMTP server-Enter the secure server name:  
**Example: mail.mydomain.com**
- Port-Enter the secure port number: **587**
- Security type-Select **None**.

**Note:** Be sure the **Port** number is still **587**.

11. Tap the **Require sign-in** checkbox.
12. In the **Username** box, enter your entire email address (e.g., myname@mydomain.com).
13. In the **Password** box, enter the password associated with your email account.
14. Tap the **Next** button. The device will connect to the internet and check your outgoing settings.
15. On the **Account options** screen, make changes, as desired.

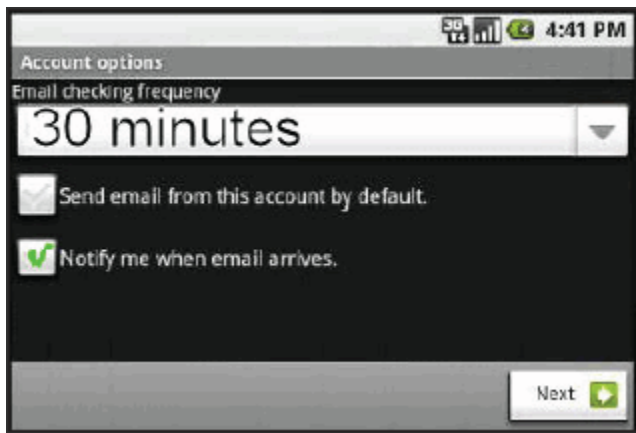

16. Tap the **Next** button. On the **Set up email** screen, enter your name in the **Type your name** field. This is the name that will be displayed in the **From** field of email messages you send. Tap the **Done** button.